

2026 Tarrant County CycleNation

May 7, 2026

Event Map

Lower Level Event Lawn
Loews Arlington Hotel & Conference Center

Level One

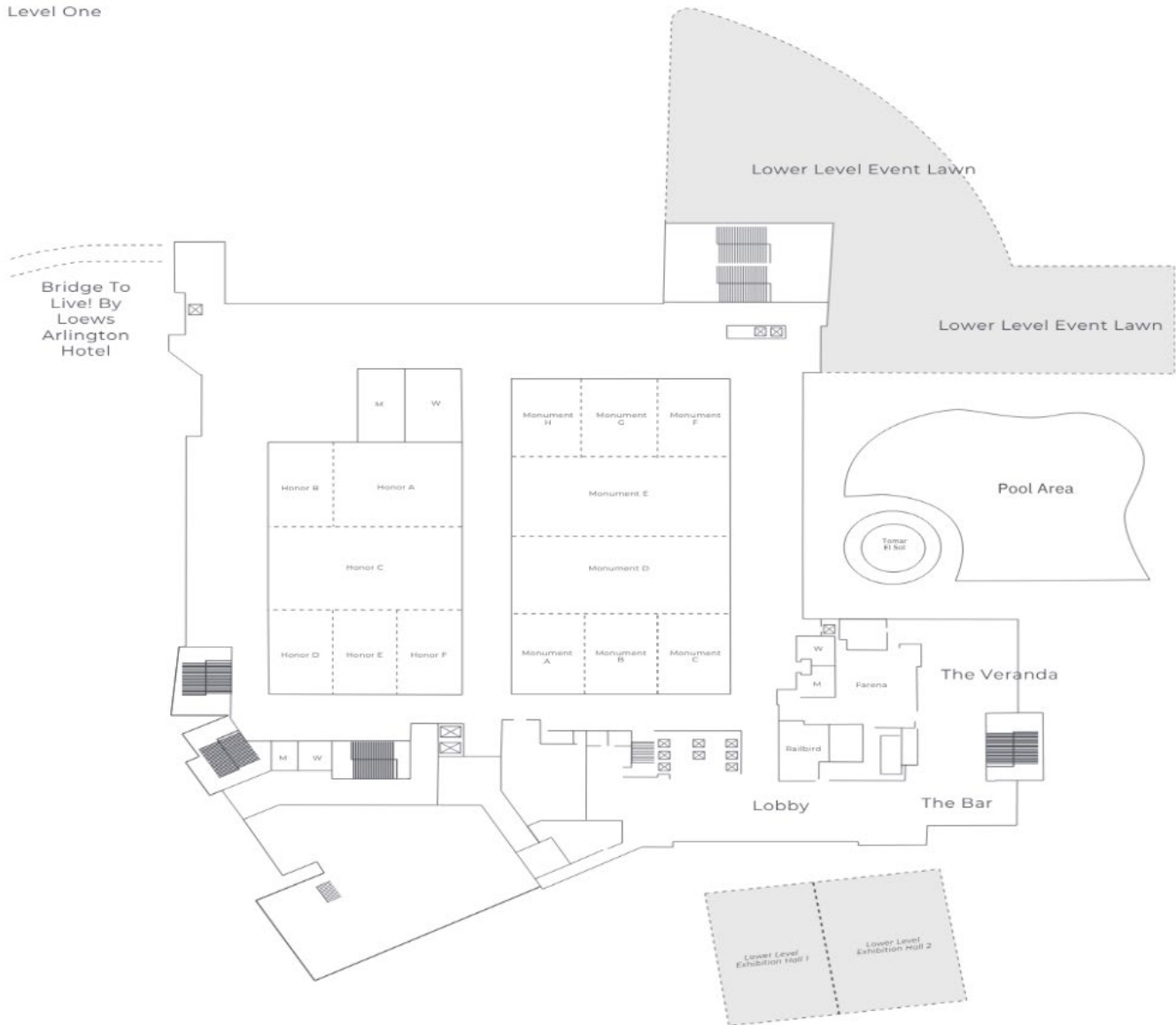

Bridge to Live! by Loews Arlington (West Side Entry)

After crossing the bridge into the hotel, walk east approximately 350 ft toward the Conference Center.

Turn right (south) and continue approximately 200 ft to the Conference Center elevators.

Take the elevators down one level to the Lower Level.

Exit the elevators, turn east, and follow the corridor to the Event Lawn approximately 350 ft.

From Outside Parking Areas

From Self-Parking (Garages or Surface Parking)

- From the parking area, go north approximately 300 ft to the pedestrian path toward the Hotel Main Entrance.
- Enter the hotel through the north automatic sliding doors at the Main Lobby (Level One).
- Once inside, turn northeast and proceed toward the Conference Center approximately 250 ft.
- Continue northeast through the lobby and pre-function corridor until you reach the Conference Center elevator bank approximately 400 ft.
- Take the elevators down one level to the Lower Level.
- Exit the elevators, turn east, and walk along the corridor to the Event Lawn approximately 350 ft.

From the Main Lobby (Level One)

- Walk through the north main lobby windows/entrance.
- Turn northeast and walk toward the Conference Center corridors approximately 250 ft.
- Continue northeast until you reach the public elevators near the conference pre-function space approximately 400 ft.
- Take the elevators down one level to the Lower Level.
- Exit the elevators, turn east, and walk along the corridor to the Event Lawn approximately 350 ft.

From the Conference Center Elevators (Lower Level)

- Exit the elevators and turn east.
- Follow the corridor heading east-southeast toward the Lower Level Event Lawn approximately 300 ft.
- Continue straight through the pre-function area approximately 150 ft.
- The Event Lawn entrance will be ahead, accessed via a pathway leading south onto the lawn area approximately 75 ft.

Restroom Locations

- Main Lobby (Level One): Restrooms are located near the lobby and pre-function areas.
- Lower Level: Restrooms are available near the conference pre-function space adjacent to the Event Lawn corridor.

Parking Information

Accessible and General Parking

- Accessible parking is available in both garages and designated surface parking areas, located closest to pedestrian paths and hotel entrances.
- All primary routes from parking areas to the Event Lawn are ADA accessible, including automatic doors, elevators, and wide interior corridors.

For questions, please contact Jennifer Swofford at Jennifer.Swofford@heart.org or call (817) 698-5403.